

CONFERENCE CENTER FLOOR PLANS AND CAPACITIES

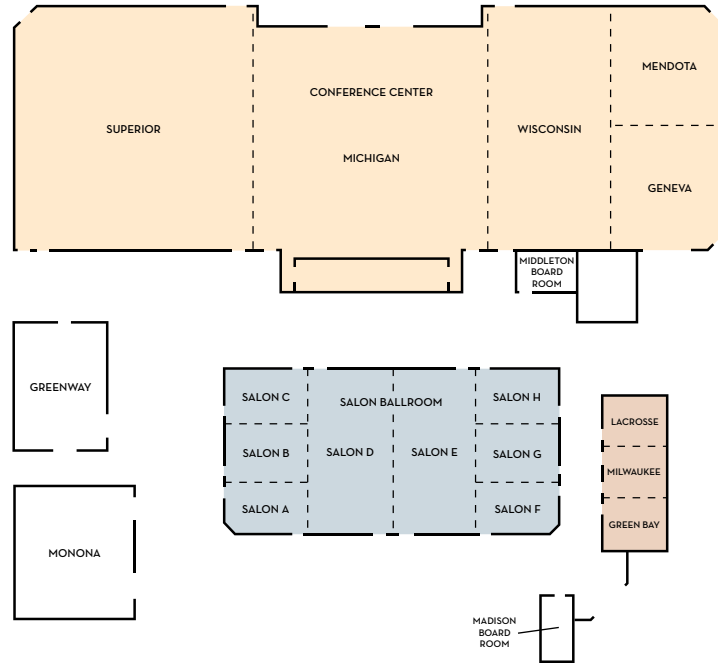

Room	Dimensions	Area (Sq. Ft.)	Ceiling Height	Reception	Rounds	Classroom	Theater	Conference	U-Shape	Exhibit
Salon Ballroom	140' x 70'	10,000	16'	1,200	550/10 rds 600/12 rds	400	800	-	-	60
Salon Ballroom A	35' x 23'	805	16'	80	40	40	60	25	20	8
Salon Ballroom B	35' x 24'	840	16'	100	40	40	60	25	20	8
Salon Ballroom C	35' x 23'	805	16'	80	40	40	60	25	20	8
Salon Ballroom D	70' x 35'	2,450	16'	300	140	132	225	60	48	28
Salon Ballroom E	70' x 35'	2,450	16'	300	140	132	225	60	48	28
Salon Ballroom F	35' x 23'	805	16'	80	40	40	60	25	20	8
Salon Ballroom G	35' x 24'	840	16'	100	40	40	60	25	20	8
Salon Ballroom H	35' x 23'	805	16'	80	40	40	60	25	20	8
Green Bay	26' x 21'	545	12'	50	30	25	45	20	17	4
Milwaukee	26' x 22'	575	12'	50	30	25	45	20	17	4
La Crosse	26' x 21'	545	12'	50	30	25	45	20	17	4
Middleton Boardroom	26' x 24'	792	9'	45	30	30	45	20	17	3
Madison Boardroom	23' x 14'	322	10'	-	-	-	-	16	-	-
Greenway	42' x 35'	1,300	10'	150	80	65	100	20	28	-
Monona	55' x 52'	2,860	10'	225	150	90	150	42	30	15
Conference Center	302' x 96'	30,000	26'	3,800	1,500/10 rds 1,800/12 rds	1,584	2,700	-	-	180
Superior	100' x 96'	10,000	26'	1,200	800	528	900	-	-	60
Michigan	100' x 96'	10,000	26'	1,200	800	528	900	-	-	60
Wisconsin	50' x 96'	5,000	26'	600	400	264	450	-	-	30
Mendota	50' x 48'	2,500	26'	300	120	132	225	40	-	15
Geneva	50' x 48'	2,500	26'	300	120	132	225	40	-	15

MEETING SPACE INFORMATION

- More than 50,000 total square feet of flexible event space for as many as 3,800 guests
- As many as 19 meeting spaces, including a 30,000-square-foot conference center and 10,000-square-foot ballroom
- Room capacities listed are for seating only and do not include space for buffets, head tables, stages, etc.

MEETING FACILITIES

- High-speed Internet access and state-of-the-art audiovisual technology available in every room
- Experienced staff on property to arrange catering, technology and all other event needs